

We look forward to welcoming you
into our Post 16 Partnership
and our exciting future...

Cromwell Community College
in Post 16 Partnership
with
Neale-Wade Community College

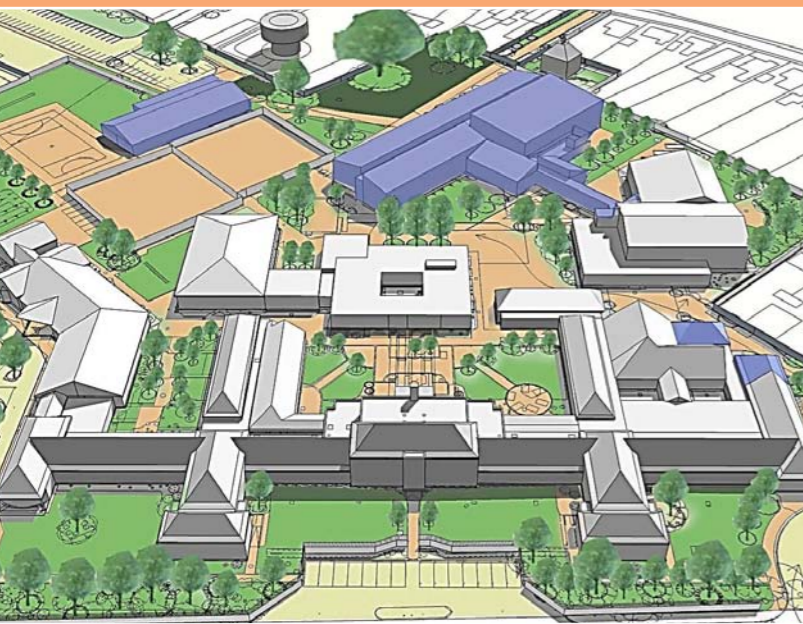

Jon Varey
Director of Post 16 Studies
Cromwell Community College
Wenny Road, Chatteris,
Cambridgeshire PE16 6UU
T: (01354) 692193
F: (01354) 695952
Email: jvarey@cromwell.cambs.sch.uk

Natalie Lamb
Head of Post 16
The Neale-Wade Community College
Wimblington Road, March,
Cambridgeshire PE15 9PX
T: (01354) 653430
F: (01354) 659429
Email: lambn@neale-wade.cambs.sch.uk

Working with you as part of the Fenland Partnership

**Widening opportunities
for Fenland Students**

Welcome to our partnership: preparing young people for life in the 21st Century

This is a very exciting time for Cromwell and Neale-Wade and for the students we serve. We strongly believe that learning does not end at 16 and that young people should be encouraged to view being part of a Sixth Form as the staging post for the next step of their journey through lifelong learning.

Being a student beyond compulsory schooling is a vital time for young people to realise their personal and intellectual potential by helping them to achieve the skills, values, attitudes and knowledge to equip them for life in the 21st Century.

We are delighted to be able to offer the sixth form experience and we are confident that our students will benefit from Post 16 education which is based in their local area.

What are the benefits of being in a partnership?

Being part of a partnership means that students can access many more courses than they would from just one centre.

Another advantage is that students can use the facilities at both Colleges, meet new people and experience new teaching environments.

We believe that a partnership like ours offers a wide range of opportunities all round whilst at the same time providing the stability young people need to widen their opportunities.

What is available?

Being part of a partnership means we are able to offer a range of AS, A2 and AVCE courses. Students can access these courses at either Cromwell or Neale-Wade or a combination of both.



We have worked hard to establish the curriculum which we think most students will benefit from. Currently these are the courses on offer at present. * Courses will only run if there is sufficient student uptake and staff availability.

Cromwell

Art and Design	IT (OCR National Level 3)
Biology	Mathematics
Chemistry	Psychology
English Lit	Product Design
Geography	Public Services
Government & Politics	Religious Studies
Hair & Beauty – Level 2	Sport (BTEC)
Health and Social Care	Sports Studies
History	Textiles

Neale-Wade

Applied Business	French
Applied Media	Geography
Art and Design	German
Biology	History
BTEC National Applied Science Level 3	IT – Double Award
Business Studies	Mathematics
Catering	Media Studies
Chemistry	Music
Childcare – Level 2 and 3	Physics
Drama	Psychology
English (Language and Literature)	Sociology
English Literature	Sports Studies
	Technology
	Work Skills – Level 3

If students wish to opt for courses which are not on Cromwell's list but which are offered as part of the Partnership, they are able to do so at Neale-Wade. Students can combine courses from the two lists.

What GCSEs do I need to access these courses?

We want students who embark on these courses to be successful and so have set realistic entry requirements. Generally speaking we ask that students have 5 GCSEs at A*-C (from Higher Tier papers), usually with at least a C in the subjects they choose to study. However, some subjects such as Maths and Science will require B's.

Subject Selection

Traditional Pathway

- Preferably 5A*-B including English and Maths to study 4 AS's
- 5A*-C including English and Maths to study 3AS's (Students may need to have a B in the subject they wish to study)

Non-Traditional Pathway

- 4A*-C to study a BTEC/OCR double award + 1AS
- 5A*-C to study an Advanced Diploma (Students in the second pathway who do not achieve a C or above in English or Maths will be required to attend additional lessons and re-sit in year 12)

A2 Results 2011

A – E % pass rate 98%

A – C % pass rate 62%

Do I have to wear uniform?

We do not have a uniform but we do expect students to dress appropriately. Extreme hairstyles, facial piercings and visible tattoos are not acceptable.

What other support will I get?

Post 16 students have a group tutor who looks after their progress and welfare. For most students their tutor is based at their "home" institution. If a student chooses courses which means they are mostly taught at Neale-Wade then their tutor base is likely to be there.

Tutors are able to advise on the whole range of Post 16 issues which will help equip young people for life in the outside world. Careers and university applications will be a focus for the Tutorial Programmes.

Liaison between home and school continues to be important, and student progress is monitored and reports sent home at regular intervals throughout the course.

The Heads of Sixth Form at Cromwell and at Neale-Wade liaise regularly to ensure that everything is running smoothly and to address any concerns students or their parents and carers may have.

What about transport?

One of the benefits of this partnership is that students do not have to make long journeys.

The Local Authority makes some contribution to the cost of transport for Post 16 students.

A free minibus service runs for those students who need to travel between institutions during the school day.

Is there any help with the cost?

In June 2011, the Government announced the introduction of the 16-19 Bursary with effect from September 2011. Cromwell Community College, in common with other Cambridgeshire Schools, has contracted the County Council to administrate Bursaries on their behalf. The Government has directed the following eligibility criteria for students who are under 19 in the academic year when they start their course of study.

1. Young people in care, care leavers, young people in receipt of income support and disabled young people in receipt of Employment Support Allowance who are also in receipt of Disability Living Allowance.
2. Young people who are eligible to receive Free School Meals.
3. Young people whose household income is below £20,817 per annum;
4. Young people who have been affected by a sudden, exceptional change in financial circumstances.

What other opportunities will be available?

Students are encouraged to join a committee to experience team work and be involved with major decision making. V group offers students the opportunity to get involved with voluntary work in and out of college. This is accredited.

In addition to all this there will be a full calendar of social and charity fundraising events, which students will help to organise.

Applications?

Full details of the application procedures are available from Cromwell or Neale-Wade.